

... for a safe journey  
in elevator cars without  
car doors.



## cegard/Lift LI

Testable safety light curtain for  
elevator cars without car doors



## Description

The protective light curtain **cegard/Lift LI** is designed to be installed in elevators where the elevator car has no doors. It is approved by TÜV in Germany according to the TRA 200, which specifies a type 2 ESPS (electro-sensitive protective system with integrated self-testing).

**cegard/Lift** is an alternative to the extensive work of fitting doors on an existing elevator installation which normally heavily reduces both volume and performance.

As **cegard/Lift** in operation uses up to 46 (optional 70) beams, the optical resolution and consequently safety is thereby heavily increased.

The optional mounting kits can be supplied as either a surface mounted model or as a back wall model. The latter has the advantage that the existing net door width can be maintained. The system is designed to survey one or two lift accesses.

**cegard/Lift** can be easily connected to almost all existing elevator controllers without the need for additional elevator cables to be installed.

## Features

- Tested acc. to EN 62061: 2005, EN 61496-1, EN 61496-2: 2006 BWS type 2
- Absolutely ideal for use in elevator cabins without car doors
- Simple installation and integration with existing elevator controllers
- Test input enables the testing of the system (EN 954-1)
- No adjustments or optical alignment necessary
- Simple mounting
- Robust and compact design
- Self-calibrating

## Block circuit diagram

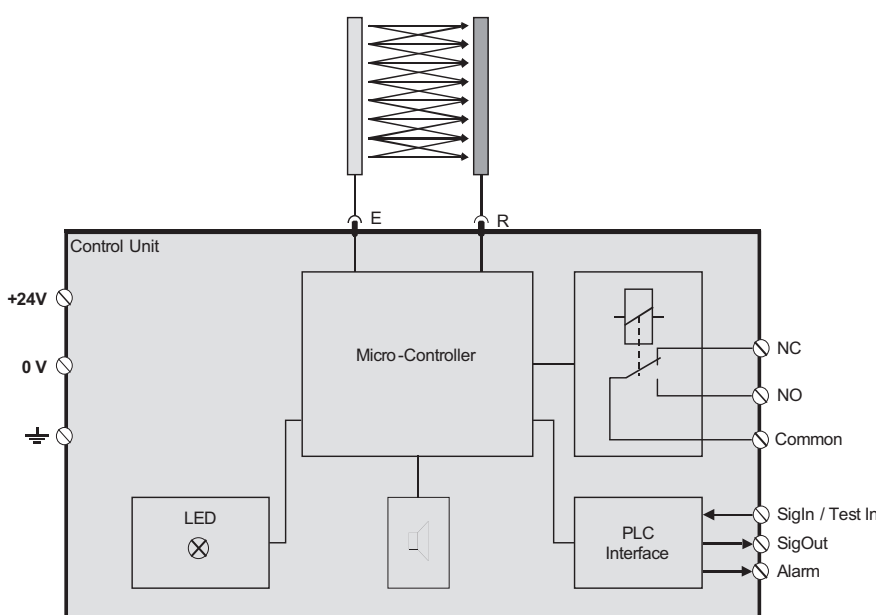

## Technical Data

Supply voltage 24 VDC  $\pm$  20 %  
Current consumption < 150 mA

### Outputs by interrupted light beam

- Relay change-over contact  
**24V / 1 A**
- 2 semiconductor outputs PNP 100 mA,  
short circuit proof
- Accoustic signal buzzer 4 kHz
- Response time output < 80 ms  
typ. 50 ms

### Input

- Test 0 ... 3 VDC "Low"  
10 ... 30 VDC "High"

### Optical edges

Cable length 6 m  
Operating range 0.7 ... 4.0 m  
Active protection field 1'630 mm  
No. of light beams 46 beams

### Enclosure rating

- Control unit IP20  
- Optical edges IP65  
Temperature range -20 ... +65°C

## Technical drawing cegard/Lift LI

### Robust control unit

Space required L x W x D = 200 x 120 x 45 mm



### Cross section of the optical edge

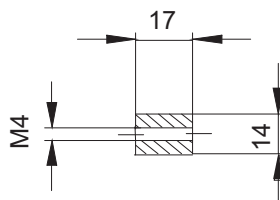

Optional: Through hole

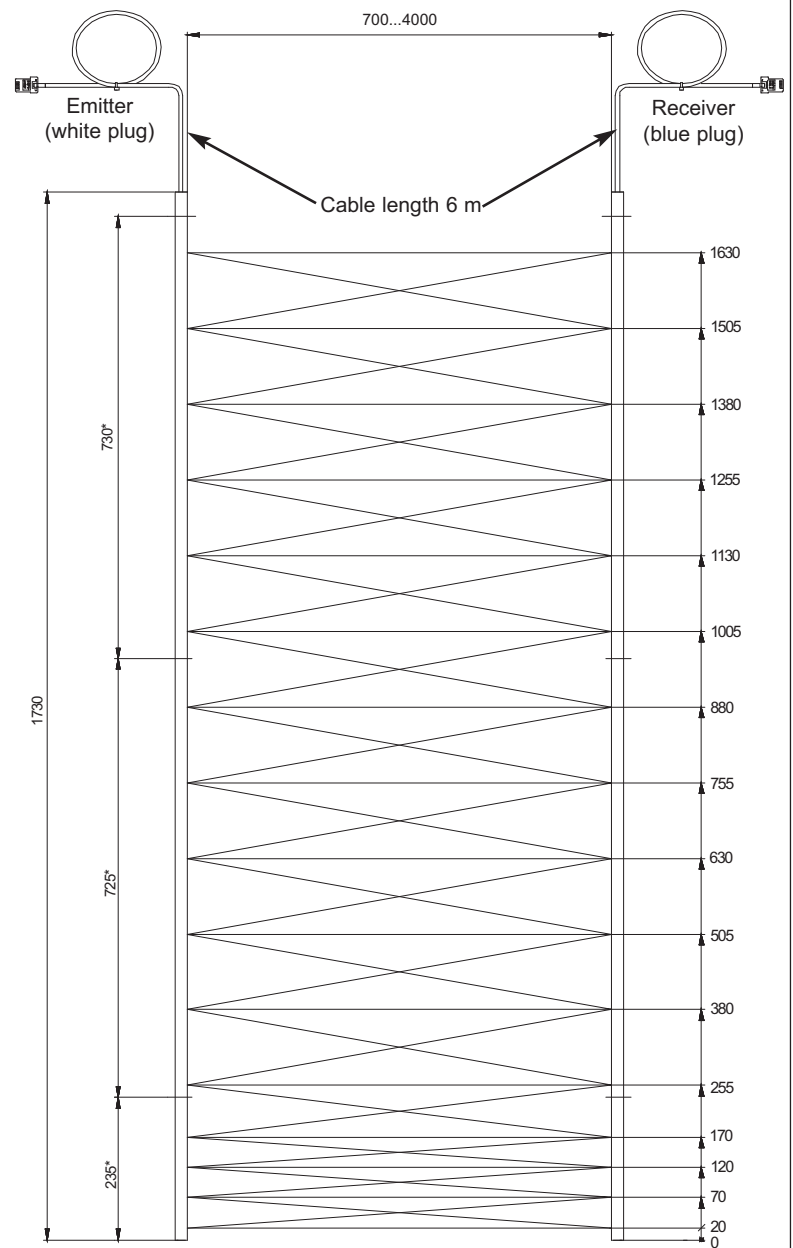

\* = Mounting holes  $\varnothing$  4.5 mm

- Optional:
- 70 beams
  - Operating range 4 ... 8 m

(All dimensions in mm)

## Order information

Part No.	Type	Description
100 891	cegard/Lift LI	Complete system with control unit, emitter and receiver edges 0.7 - 4.0 m
100 892	cegard/Lift LI	Complete system with control unit, emitter and receiver edges 4.0 - 8.0 m
100 847	Accessory	Mounting kit for flush mounting, including drill pattern, drill, (stainless steel, painted yellow-black)
100 848	Accessory	Mounting kit for surface mounting inside cabin, including drill pattern, drill, (stainless steel, painted yellow-black)
100 849	Accessory	Alarm unit to indicate emergency stop, surface mounted

Other configurations on demand, for example optical edges with 24 elements, other active protection fields or cable lengths

100706 Part No. 001 011 E

CEDES reserves the right to modify or change technical data without notice.